

Parete 01 - Spigolo A

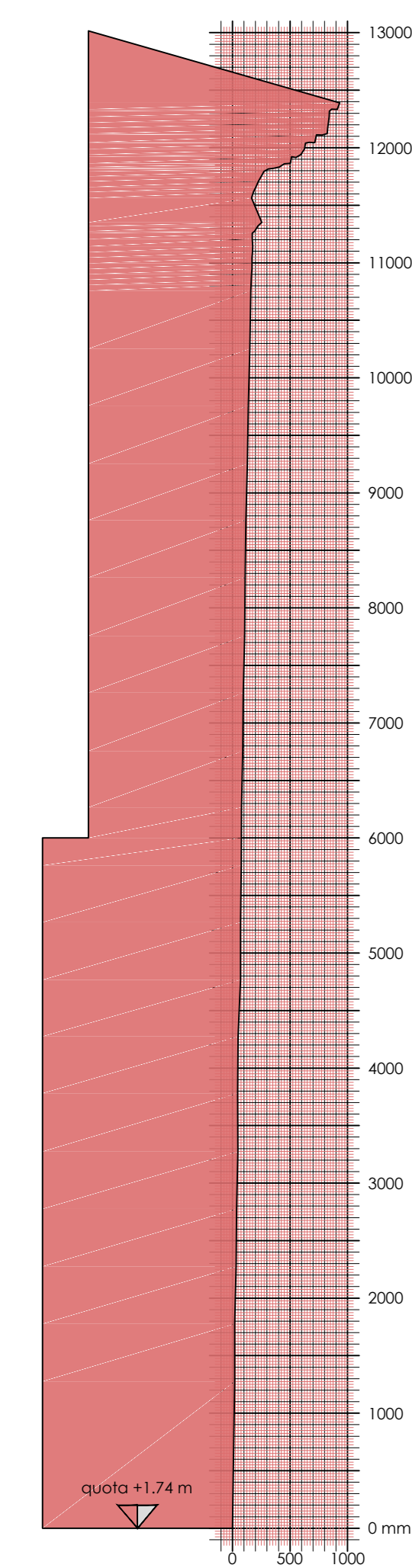

Parete 01 - Lato A-B

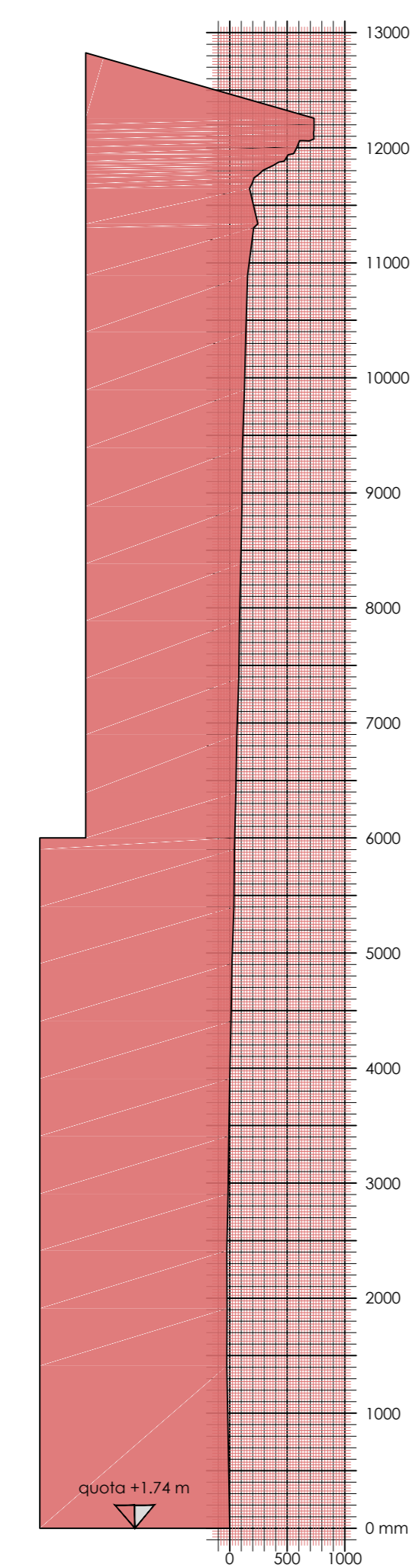

Parete 02 - Lato A-B

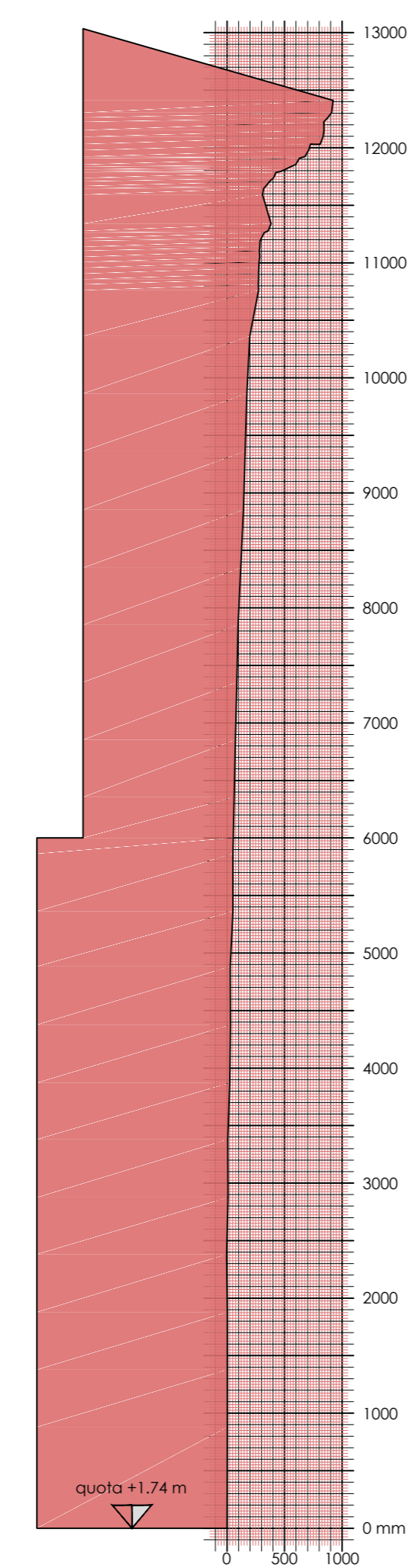

Parete 03 - Lato A-B

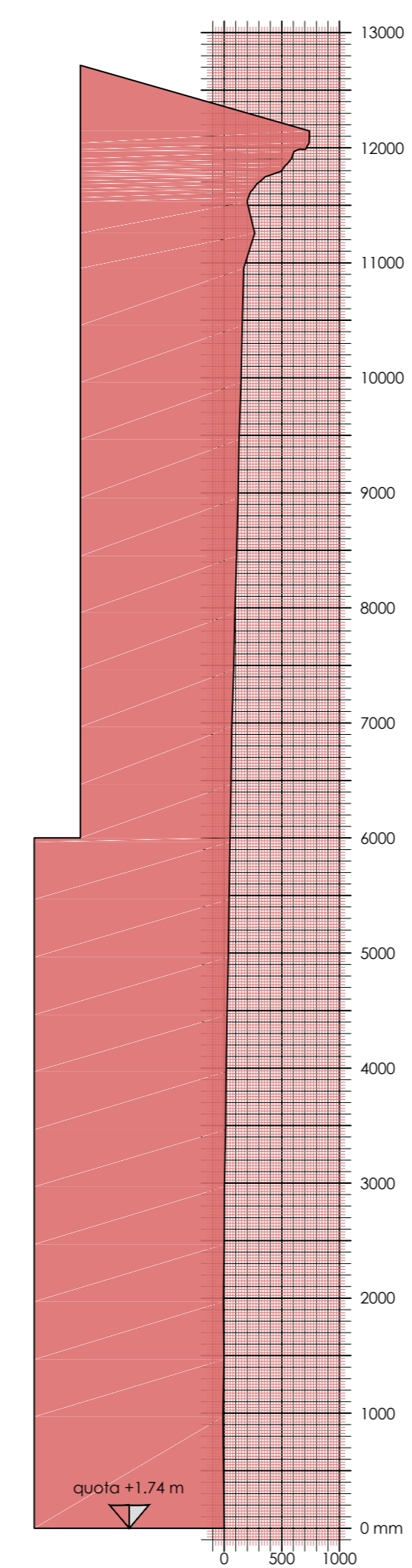

Parete 04 - Lato A-B

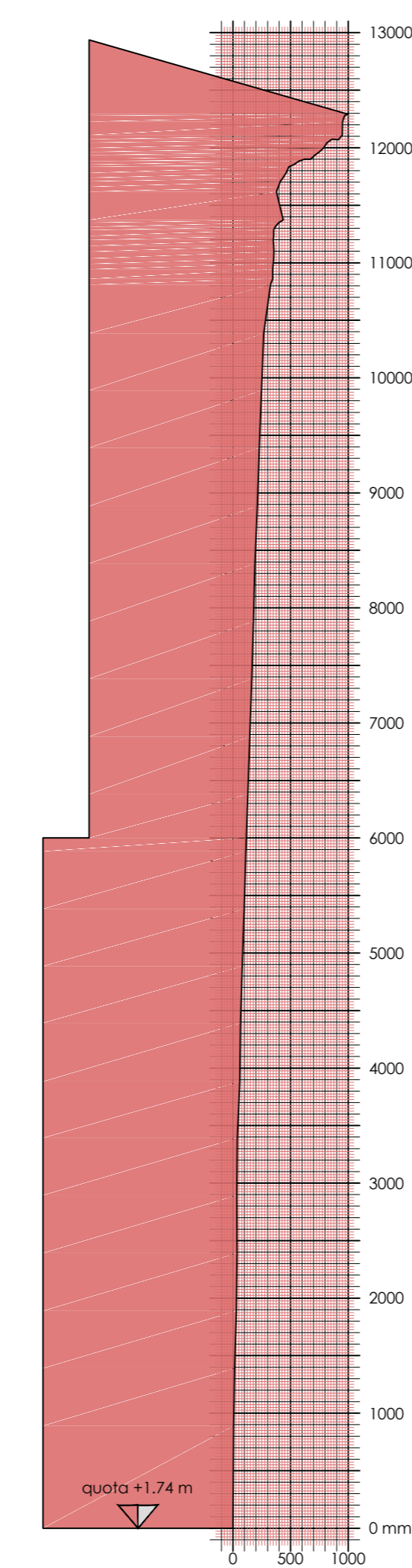

Parete 05 - Lato A-B

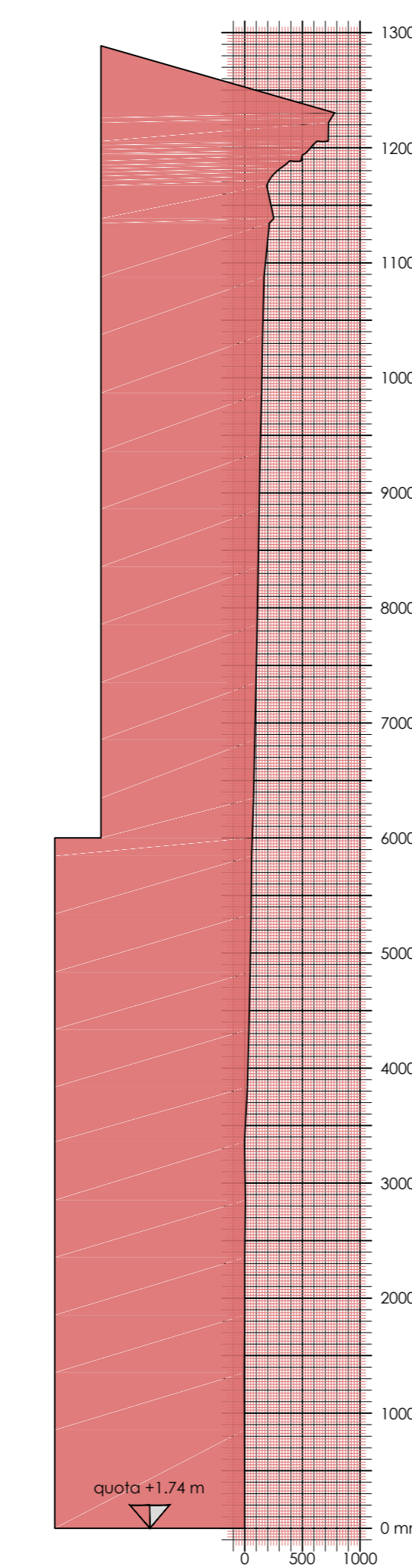

Parete 01 - Spigolo B

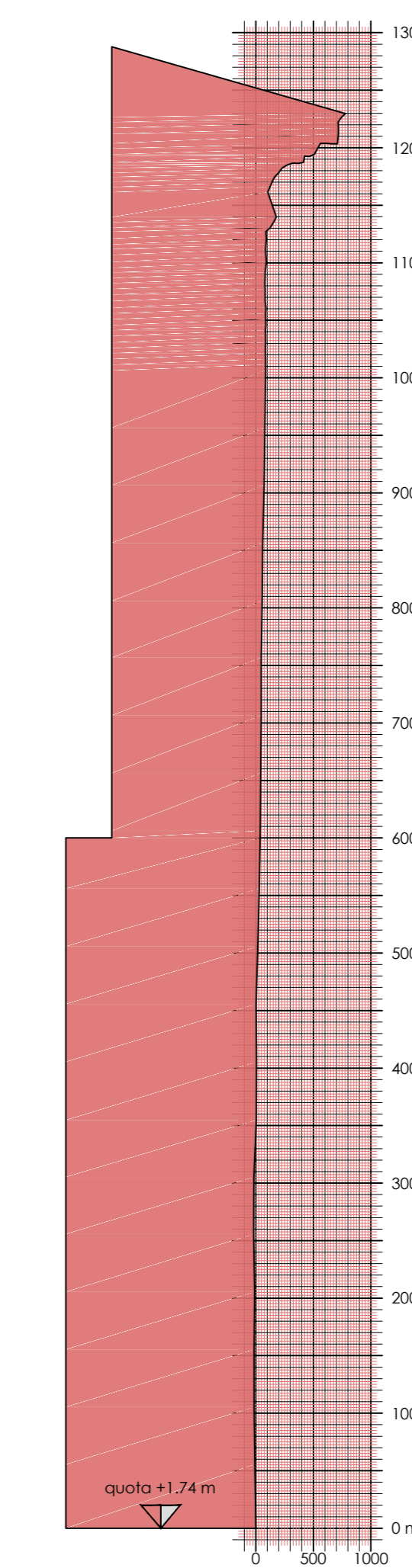

Parete 01 - Lato B-C

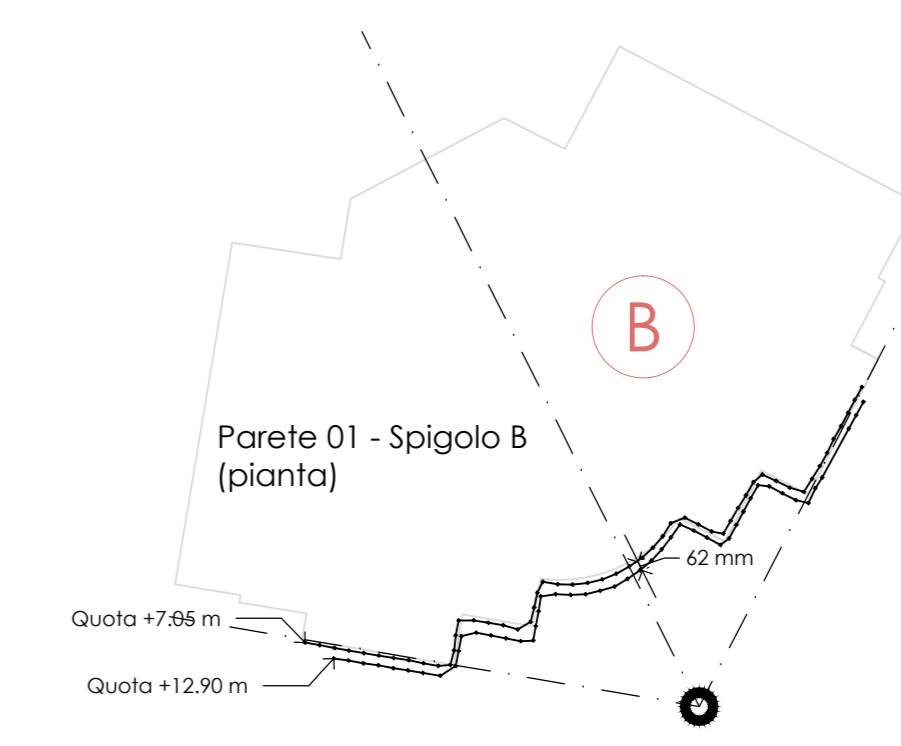
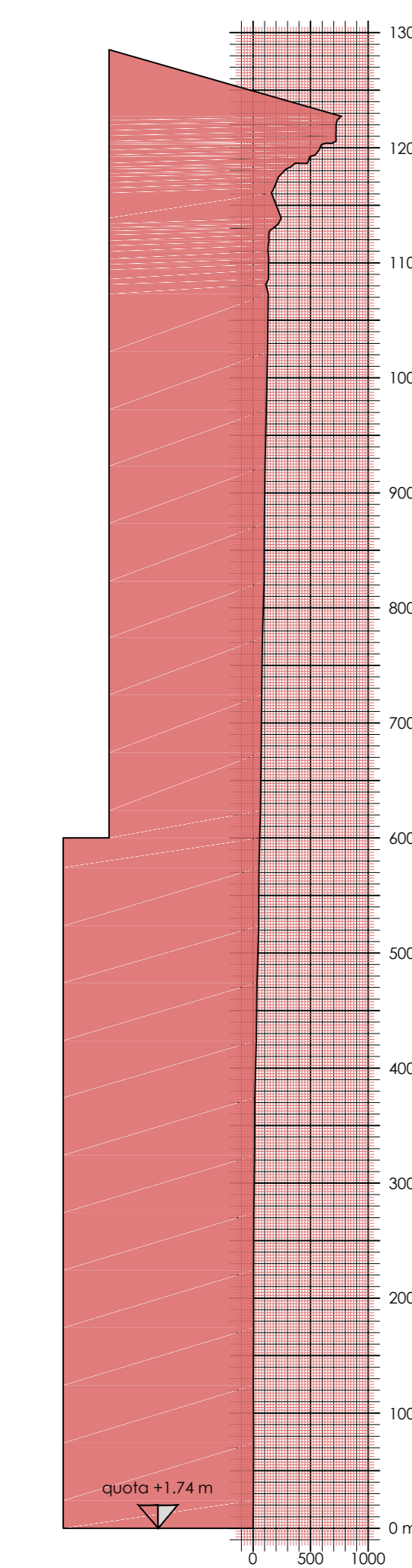

Parete 02 - Lato B-C

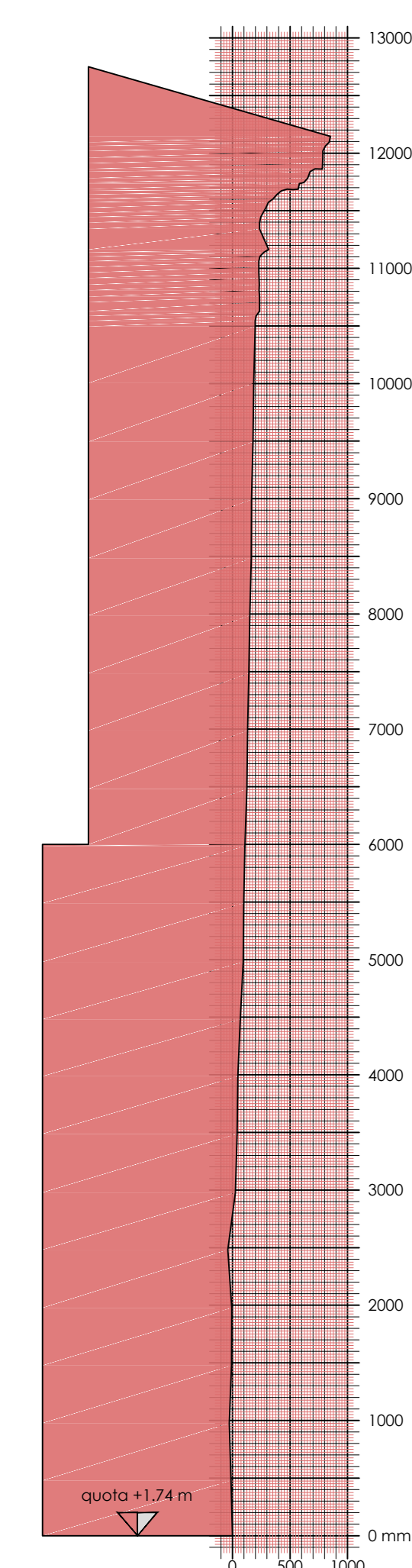

Parete 03 - Lato B-C

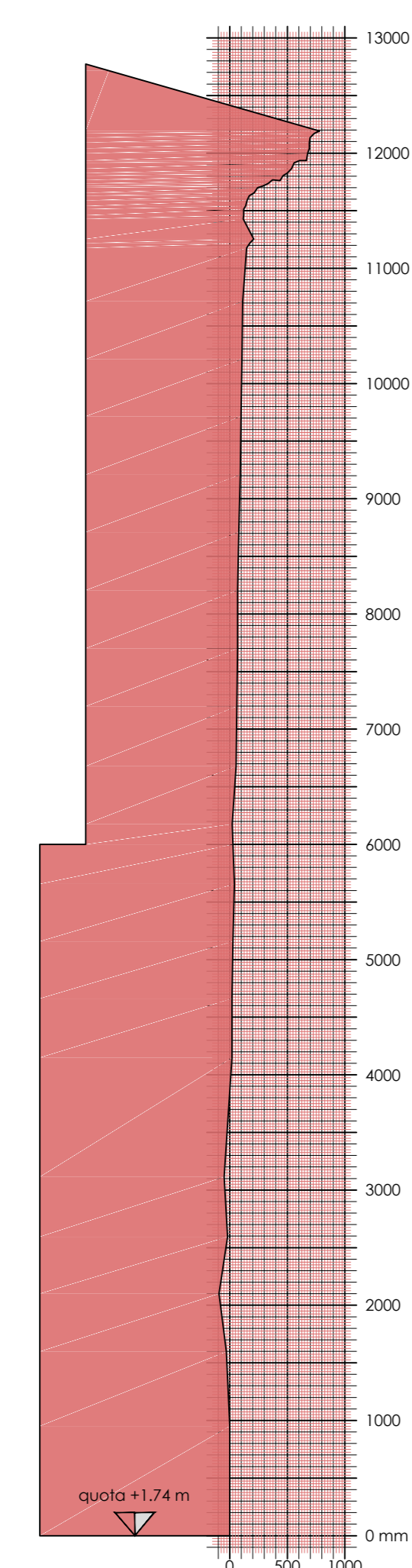

Parete 04 - Lato B-C

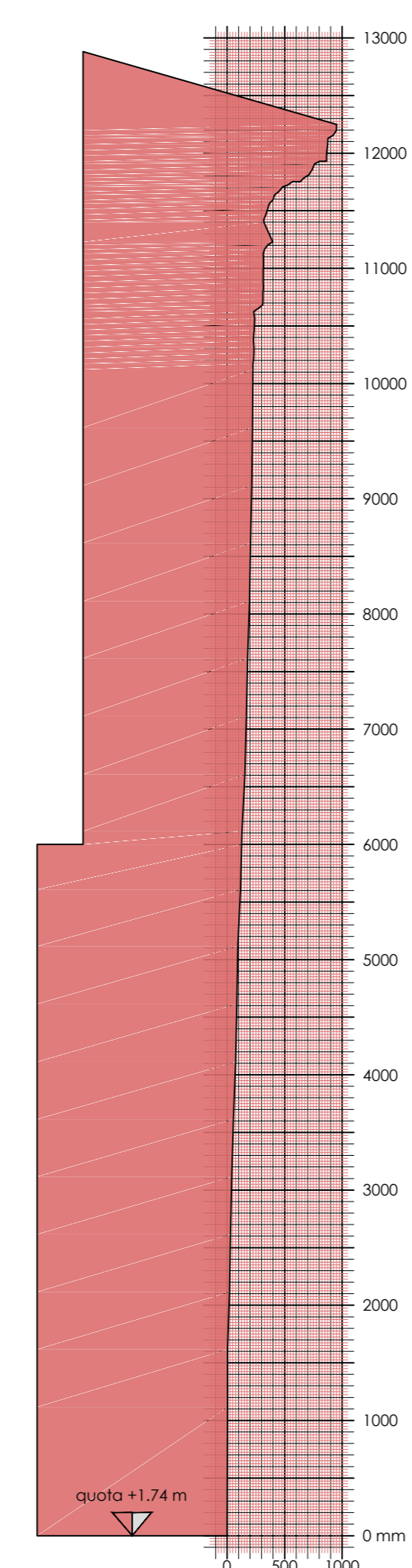

Parete 05 - Lato B-C

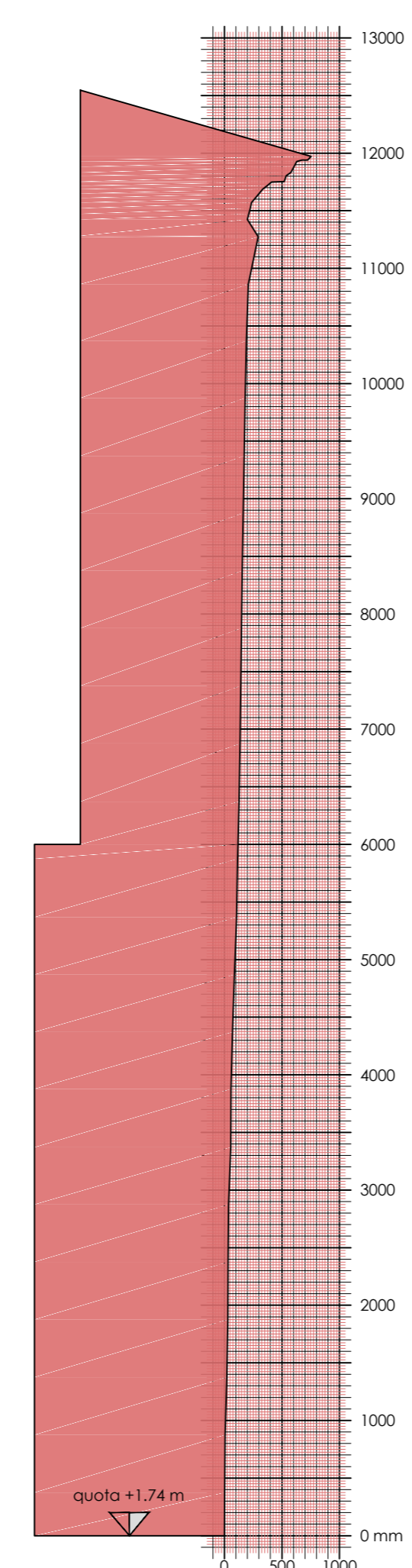

Parete 01 - Spigolo C

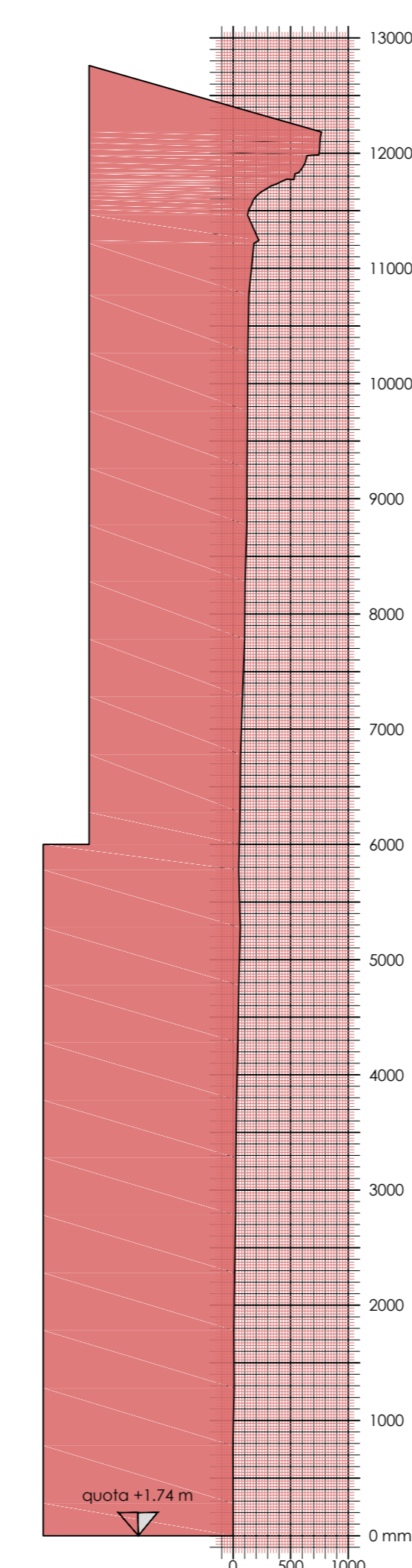

Parete 01 - Lato C-D

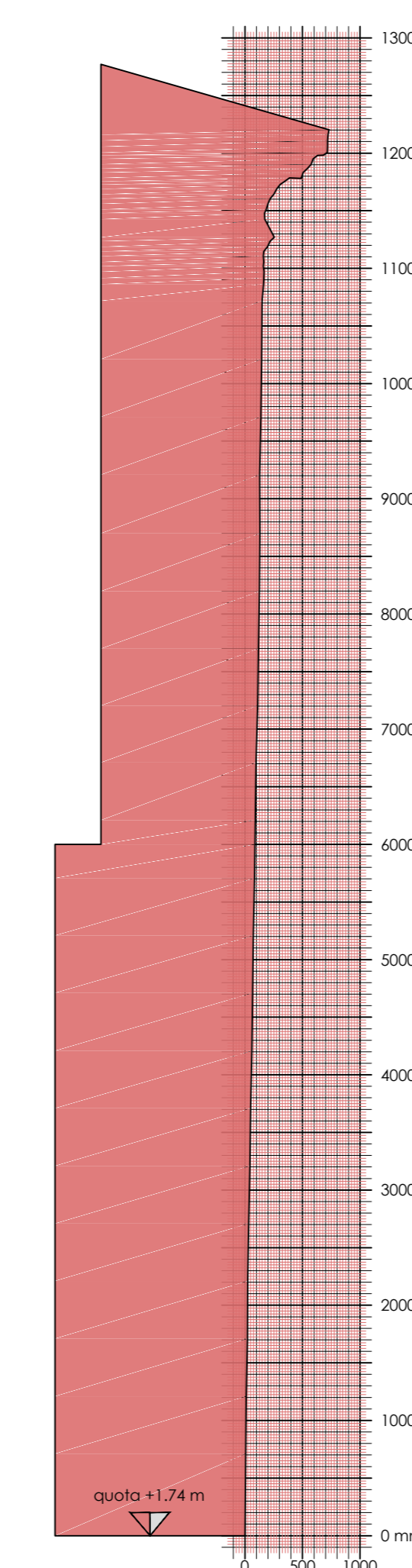

Parete 02 - Lato C-D

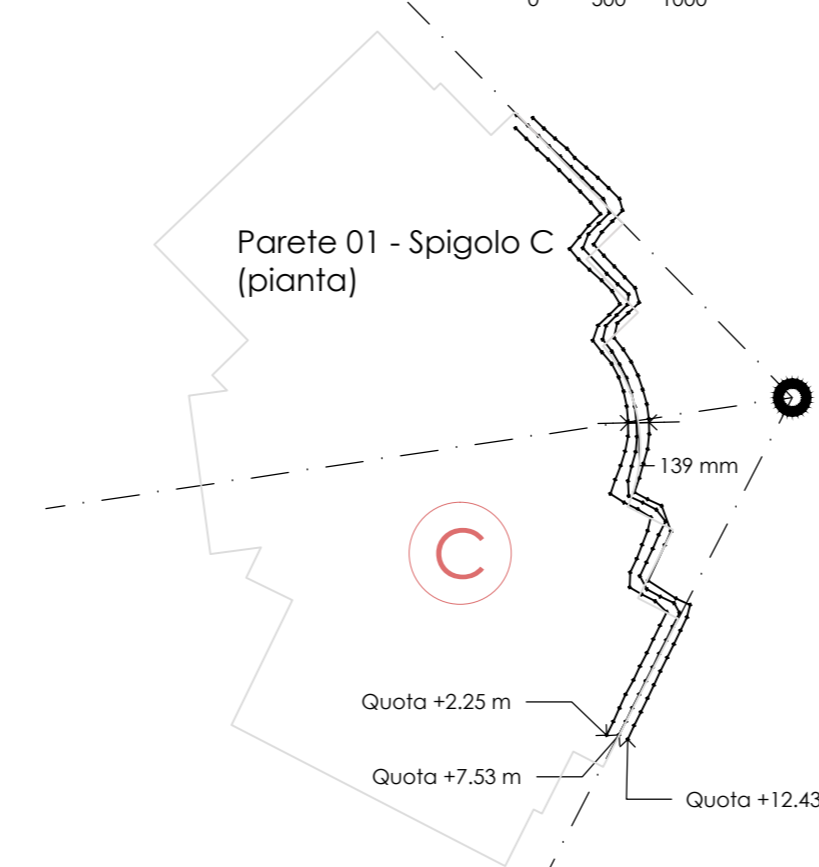
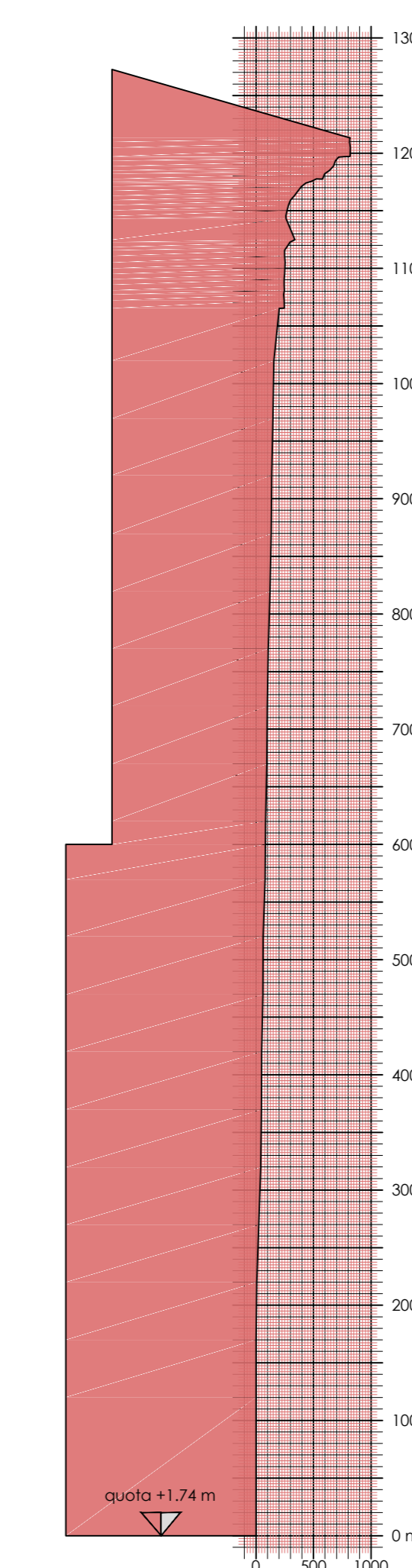

Revisione	Sostituisce codice	Disegna	V*	del	Modifica		
Comune di Ancona - Direzione Progettazioni, Manutenzioni, Viabilità, Frana e Sicurezza					Disegno	05	
Rilievo critico delle strutture del complesso edilizio della Mole Vanvitelliana di Ancona e coordinamento e l'assistenza alle indagini e prove sui materiali					Modifica	A	
RILIEVO GEOMETRICO DI CONTROLLO Misurazioni ad alta precisione Sezioni verticali delle pareti esterne (1 di 2)					Serie	RC	
Elaborato	001-16_RC.05.A001	Disegnato	01.02.2016	Scala	1:50	Revisione	M, F.
Ing. Massimo Formica viale Carducci, 21 - 62019 Recanati (MC) e-mail: massimoformica@tin.it Progettato: tel. +39 338 3073928							